

# Daybreak Loop

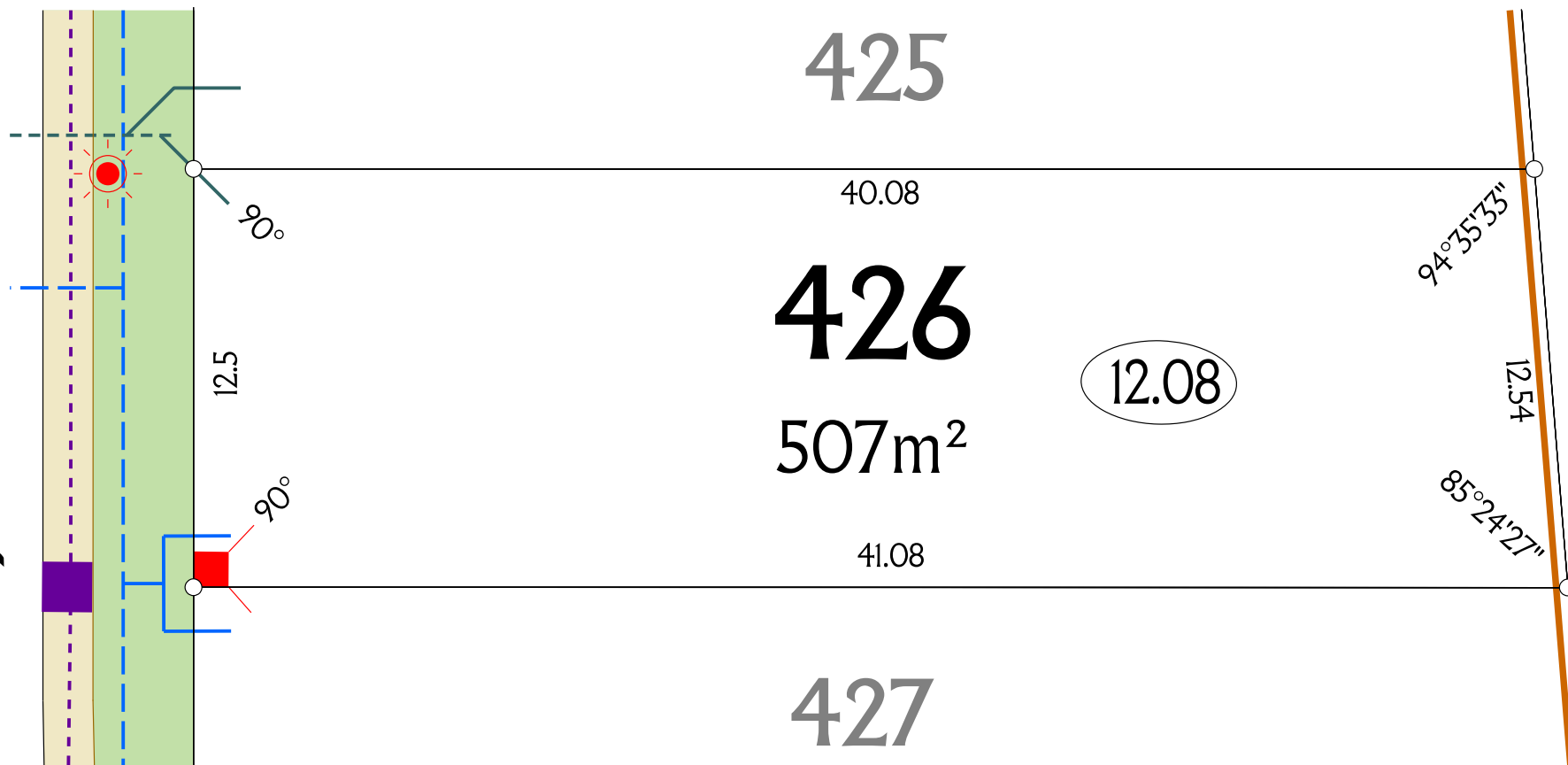

It is acknowledged that the dimension and areas, as well as location of services and the existence and width of easements are subject to change in accordance with the requirements of any relevant Authority. The particulars of this brochure are supplied for information only representing the facts at the time of printing and may change. The particulars shall not be taken as a representation in any respect on the part of the Vendor or its Agent. Authorities should be consulted in relation to any limitations or requirements as building restrictions may apply.

October 2017

WESTERN AUSTRALIA  
17 245 5411 2222  
www.wspwpa.com.au  
www.wspwpa.com.au



- 0.1m Pedestrian Accessway (No Access to Road)
- Elec. pillar, Street Light
- Retaining Wall
- Pedestrian / Cycle Paths
- Designated Crossover

- Proposed Lot Level
- Water Main
- Sewer Line
- Sewer Easement
- Drainage Line

The service and engineering information shown is from design drawings and should not be construed as being the "as-constructed" design details.

**SCALE 1:200**

0 5 metres



# Daybreak Loop

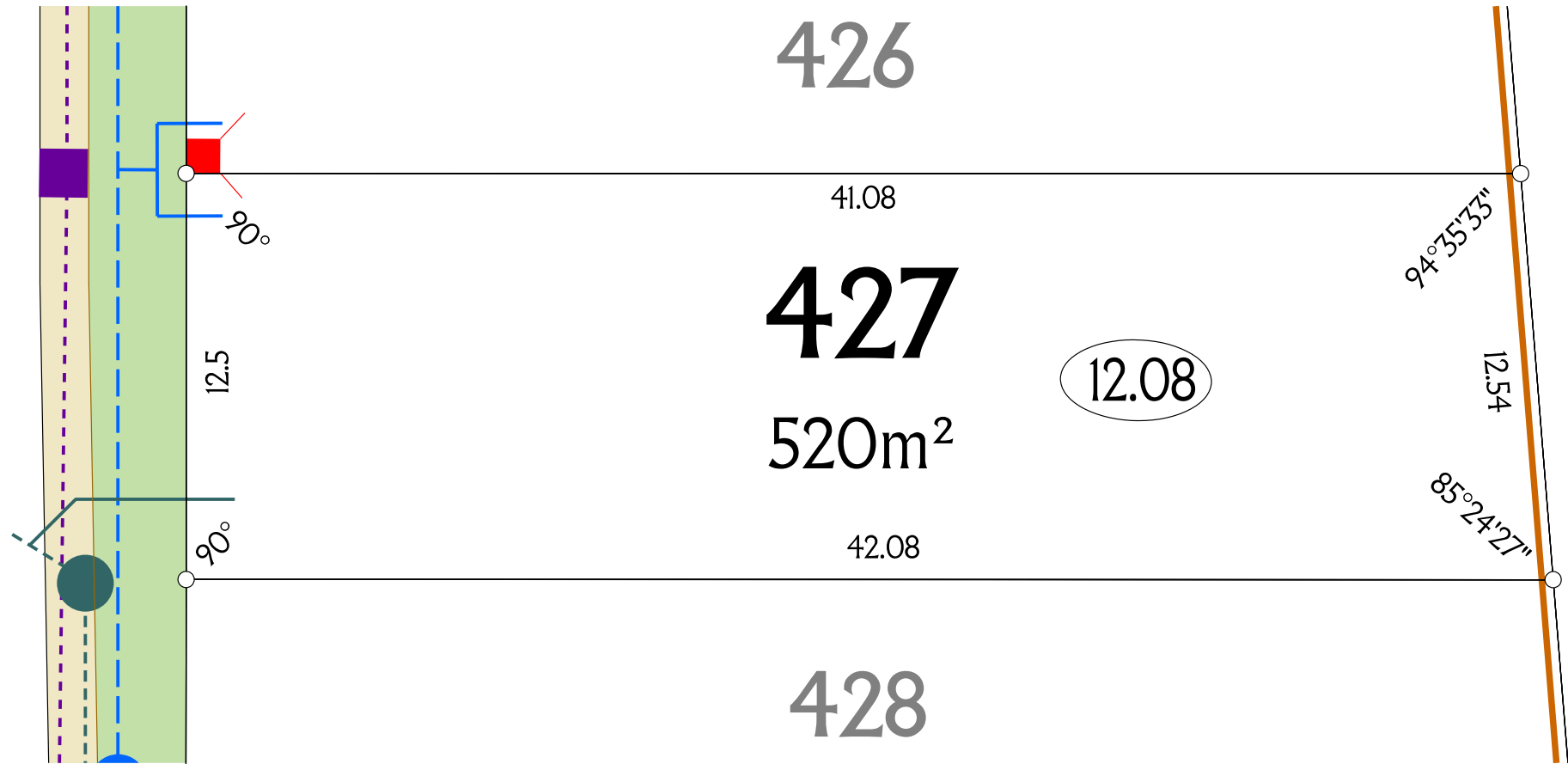

It is acknowledged that the dimension and areas, as well as location of services and the existence and width of easements are subject to change in accordance with the requirements of any relevant Authority. The particulars of this brochure are supplied for information only representing the facts at the time of printing and may change. The particulars shall not be taken as a representation in any respect on the part of the Vendor or its Agent. Authorities should be consulted in relation to any limitations or requirements as building restrictions may apply.

October 2017



- 0.1m Pedestrian Accessway (No Access to Road)
- Elec. pillar, Street Light
- Retaining Wall
- Pedestrian / Cycle Paths
- Designated Crossover

- Proposed Lot Level
- Water Main
- Sewer Line
- Sewer Easement
- Drainage Line

The service and engineering information shown is from design drawings and should not be construed as being the "as-constructed" design details.

**SCALE 1:200**

0 5 metres



# Daybreak Loop

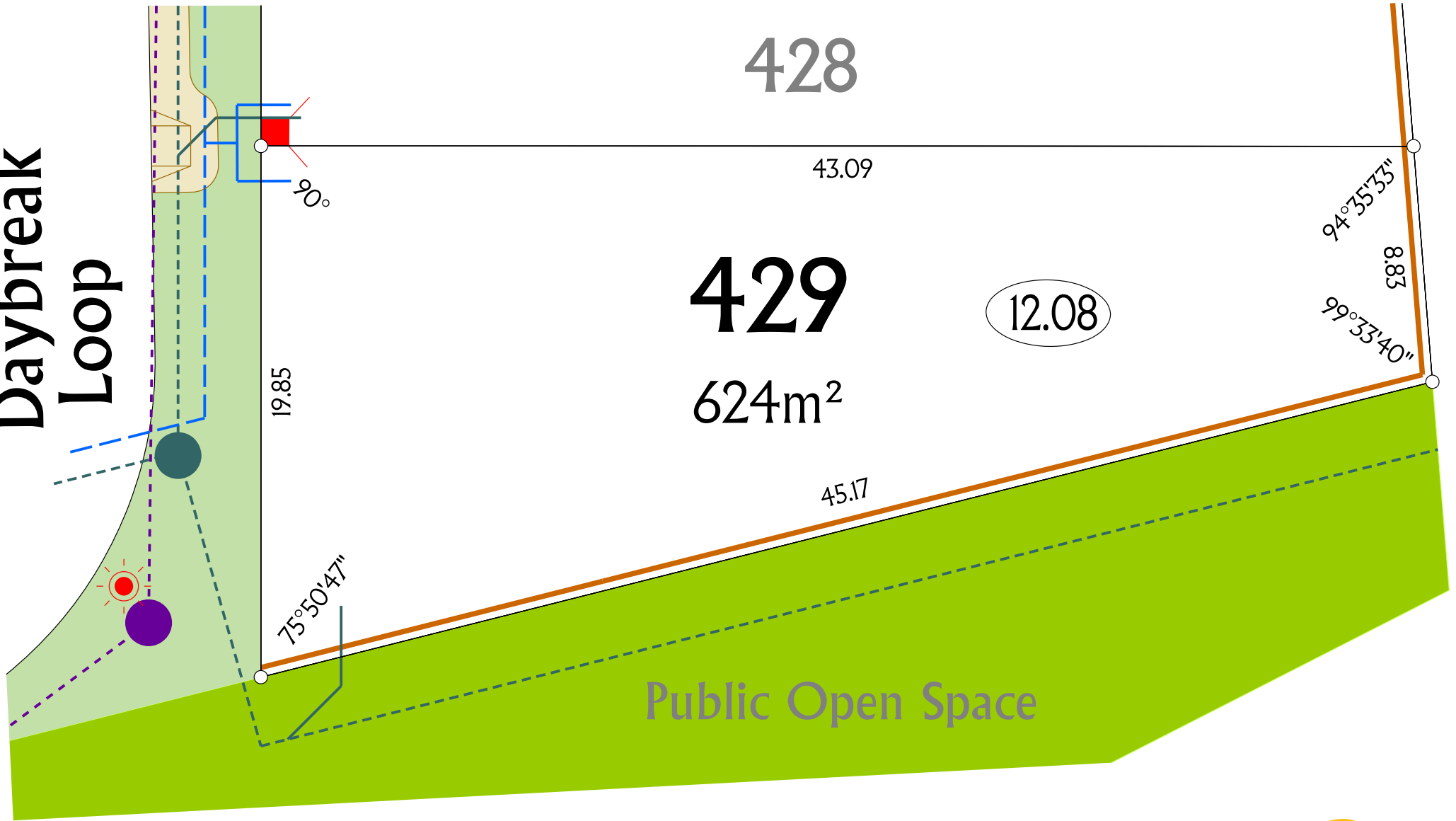

It is acknowledged that the dimension and areas, as well as location of services and the existence and width of easements are subject to change in accordance with the requirements of any relevant Authority. The particulars of this brochure are supplied for information only representing the facts at the time of printing and may change. The particulars shall not be taken as a representation in any respect on the part of the Vendor or its Agent. Authorities should be consulted in relation to any limitations or requirements as building restrictions may apply.

October 2017



- 0.1m Pedestrian Accessway (No Access to Road)
- Elec. pillar, Street Light
- Retaining Wall
- Pedestrian / Cycle Paths
- Designated Crossover

- Proposed Lot Level
- Water Main
- Sewer Line
- Sewer Easement
- Drainage Line

The service and engineering information shown is from design drawings and should not be construed as being the "as-constructed" design details.

**SCALE 1:200**

0 5 metres

